

A blue-tinted photograph of a large industrial CNC bed mill in a factory setting. The machine is complex, with various metal components, a large vertical column, and a horizontal table. The background shows a grid pattern and some blurred machinery. The text is overlaid on the image.

ATRUMP CNC BED MILL

BM SERIES

Atrump Machinery Inc.

CNC BED MILL

BM-460



BM-780



BM-880



BM-560

Specification:

Model	Unit	BM-430	BM-460	BM-560	BM-600	BM-630	BM-660	BM-760	BM-780	BM-880
Worktable	mm/inch	355x1270/14"x50"	406x1372/16"x54"	420x1600/16.5"x63"	450x1800/17"x70"	610x1854/24"x73"	762x1830/30"x72"	813x2185/32"x86"	813x2750/32"x108"	813x3200/32"x126"
T-slot	mm	16 x 3 x 64	16 x 3 x 64	16 x 5 x 60	16 x 5 x 60	18 x 5 x 70	18 x 5 x 100	18 x 5 x 100	18 x 5 x 125	18 x 7 x 100
Table load capacity	kgs	500	600	800	1000	1500	1500	1800	2000	2200
MOVEMENT										
X axis travel	m/m	800	1000	1300	1500	1500	1700	2000	2500	3000
Y axis travel	m/m	400	500	635	650	850	850	850	850	900
Z axis Travel	m/m	450	520 (600)	620	620	710	710	710	710	750
SPINDLE HEAD										
Spindle taper		BT-40 (CAT-40)	BT-40 (CAT-40)	BT-40 (CAT-40)	BT-40 (CAT-40)	BT-40 (CAT-40)	BT-40 (CAT-40)	BT-40 (CAT-40)	BT-40 (CAT-40 DIN40)	BT-50 (CAT-50 DIN50)
Spindle speed	rpm	8000 / Op:(10000,12000)							6000	6000
Feed Rate	m/min	0-5	0-5	0-5	0-5	0-5	0-5	0-5	0-10	0-10
Ballscrew diameter	m/min	Ø32	Ø32	Ø40	Ø40	Ø40	Ø50	Ø50	Ø50	Ø80 (Ø63)
Rapid travel	m/min	0-10	0-10 (0-20)	0-10 (0-20)	0-10 (0-20)	0-10 (0-20)	0-10 (0-20)	0-10 (0-20)	0-10 (0-20)	0-10 (0-20)
MOTORS										
Spindle motor	HP	7.5	10	10	10 (15)	15	15 (20)	15 (20)	20	20
Tool storage capacity		(16)	(16)	(16;20)	(20;24)	(20;24)	(20;24)	(20;24)	(20;24)	(20;24)
N.W.	kgs	2700	2900	3600	4000	4800	6400	6800	9500	14600/1100/800
G.W.	kgs	3000	3200	4000	4300	5200	6800	7200	10000	15000/1500/1000
Packing measurement	cm	181x226x240	191x226x250	262x226x254	262x226x254	310x226x254	315x226x254	315x226x254	323x228x254 270x226x100	610x228x254 240x226x150 180x226x110

Specification and design are subject to change without notice

MACHINE FEATURES:

- This machine is constructed with heavy-duty Meehanite cast iron to ensure high rigidity, wear resistance, and no deformation.
- The X, Y and Z axis slideways are coated with Turcite-B to assure smoothness and abrasion resistance.
- The X, Y, and Z axis adopt high precision double nuts pre-loaded type ball screws.
- P4-grade precision bearing is adopted for the main spindle.



- **BALL BAR :**
To ensure best accuracy & alignment in circular path, machines are inspected by ball bar tested.

HIGH RIGIDITY CONSTRUCTION WITH EXCELLENT STABILITY & PERFORMANCE

BM-660, 760 & 780



4 HARD BOX WAYS DESIGN:

Rigid, Solid and robust for a long service life.

● HIGH STRENGTH STRUCTURE:

One piece 4-box way casting, heavy-duty, hi-stability.



BM-880 only

6 HARD BOX WAYS DESIGN:

Rigid, Solid and robust for a long service life.

● HIGH STRENGTH STRUCTURE:

One piece 6-box way casting, heavy-duty, hi-stability.



● LASER CALIBRATION :

All machines are measured & calibrated using laser calibration equipment to ensure precise verification & compensation of the machines and get the best accuracy & repeatability.



SPINDLE

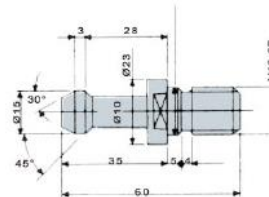

TOOL SHANK & PULL STUD :

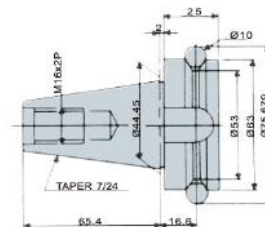

(unit:mm)

DOUBLE NUTS BALLSCREW



Machine Accessories

Standard Accessories

- Auto Lube System
- Coolant System
- Halogen Work Light
- Splash Guard
- Tool Box
- Operation Manual

Optional Accessories:

- Coolant Through Spindle
- Arm Type ATC
- Armless ATC
- Screw Type Chip Conveyor
- Belt Type Chip Conveyor
- Spindle Oil Cooler



▲ Coolant thru spindle



▲ Screw type chip conveyor



▲ Arm type tool changer



Spindle oil cooler ▶



▲ Armless type tool changer

Belt type chip conveyor ▼



THE EXCELLENT MACHINE
ATRUMP

Atrump Machinery Inc.
670 Union Ave.
Pomona, CA 91768
TEL: 1-877-4-ATRUMP
909-623 6887
FAX: 909-922-7596
www.atrump.com
Email: atrump@atrump.com